

# One Year after the 2011 Great East Japan Earthquake

- International Symposium on Engineering Lessons  
Learned from the Giant Earthquake -

March 1-4, 2012

Kenchiku-kaikan, Tokyo, Japan



## Program and Abstract Volume

### Organizing Societies

Japan Association for Earthquake Engineering  
Architectural Institute of Japan  
Japan Society of Civil Engineers  
The Japanese Geotechnical Society  
The Japan Society of Mechanical Engineers  
Seismological Society of Japan

### Supporting Organizations

Ministry of Education, Culture, Sports, Science and Technology / Ministry of Land, Infrastructure, Transport and Tourism / Ministry of the Environment / Science Council of Japan / WFEO Disaster Risk Management Committee / National Research Institute for Earth Science and Disaster Prevention / National Institute for Land and Infrastructure Management / Public Works Research Institute / Building Research Institute / Port and Airport Research Institute / Central Research Institute of Electric Power Industry

## **WELCOME TO THE SYMPOSIUM**

Welcome to the International Symposium on Engineering Lessons Learned from the 2011 Great East Japan Earthquake.

The damage due to tsunami, ground motions and liquefaction was destructive over an extensive area during the March 11, 2011 event. Fire also resulted in extensive damage. The Great East Japan earthquake revealed the fact that an infrequent and high consequence event can cause unforeseeable damage once it happened. We have to learn as many lessons as possible from this larger than expected earthquake. Furthermore, destructive damage occurred in recent earthquakes not only in Japan but also in Chile, China, Indonesia, Italy, New Zealand, Taiwan, Thailand and Turkey.

This Symposium was organized to offer a platform to bring together experts and relevant engineers who are interested in earthquake disaster mitigation worldwide (1) to identify and exchange views on damage and risk in light of the recent earthquakes, and (2) to identify future need and opportunities for joint research, cooperation among specialists, and exchange of data, information and research resources.

The Symposium was jointly organized by the Japan Association for Earthquake Engineering (JAEE), Architectural Institute of Japan (AIJ), Japan Society of Civil Engineers (JSCE), the Japanese Geotechnical Society (JGS), the Japan Society of Mechanical Engineers (JSME) and Seismological Society of Japan (SSJ) on March 1-4, 2012 in Tokyo, Japan. It is expected that the Symposium would help the advancement of short and long term objectives in earthquake disaster mitigation.

On behalf of the six organizing societies and the organizing committee, I express my profound gratitude and sincere appreciation to all participants of the Symposium for the active presentations and discussions.

March 2012

Kazuhiko Kawashima  
Chairman of the Symposium

## **ORGANIZING SOCIETIES**

Japan Association for Earthquake Engineering  
Architectural Institute of Japan  
Japan Society of Civil Engineers  
The Japanese Geotechnical Society  
The Japan Society of Mechanical Engineers  
Seismological Society of Japan

## **SUPPORTING ORGANIZATIONS**

Ministry of Education, Culture, Sports, Science and Technology  
Ministry of Land, Infrastructure, Transport and Tourism  
Ministry of the Environment  
Science Council of Japan  
WFEO Disaster Risk Management Committee  
National Research Institute for Earth Science and Disaster Prevention  
National Institute for Land and Infrastructure Management  
Public Works Research Institute  
Building Research Institute  
Port and Airport Research Institute  
Central Research Institute of Electric Power Industry

## INTERNATIONAL ADVISORY COMMITTEE MEMBERS

- Akira Wada, Japan (Chairman)  
Mitsuyoshi Akiyama, Japan  
Atilla Ansal, Turkey  
Nuray Aydinoglu, Turkey  
Patricio Bonelli, Chile  
Ruben Boroshek, Chile  
Ross W. Boulanger, USA  
Michel Bruneau, USA  
Ian Buckle, USA  
Michel Calvi, Italy  
Mehmet Celebi, USA  
K. C. Chang, Taiwan  
Shen-Wen Chien, Taiwan  
YiYi Cheng, China  
Misko Cubrinovski, New Zealand  
Amr Elnashai, USA  
Kenneth Elwood, Canada  
Peter Fajfar, Slovenia  
Matej Fishinger, Slovenia  
Satoshi Fujita, Japan  
Hiroshi Fukuyama, Japan  
George Gazetas, Greece  
Yozo Goto, Japan  
Masanori Hamada, Japan  
Fumio Hara, Japan  
Kazuro Hirahara, Japan  
Hisahiro Hiraishi, Japan  
Jun-ichi Hoshikuma, Japan  
Adnan Ibrahimbegovic, France  
Hirokazu Iemura, Japan  
Fumihiko Imamura, Japan  
Kojiro Irikura, Japan  
Kenji Ishihara, Japan  
Yumio Ishii, Japan  
Tomohiro Ito, Japan  
Tomotaka Iwata, Japan  
Toshimi Kabeyasawa, Japan  
Hiroyuki Kameda, Japan  
Kazuhiko Kasai, Japan  
Hiroshi Kawase, Japan  
Kazuhiko Kawashima, Japan  
Nobuyuki Kobayashi, Japan  
Kazuki Koketsu, Japan  
Takaji Kokusho, Japan  
Kazuo Konagai, Japan  
Kenji Kosa, Japan  
Mikio Koshihara, Japan  
Tetsuo Kubo, Japan  
Yasuko Kuwata, Japan  
Wei F. Lee, Taiwan  
Yingmin Li, China  
Zhenbao Li, China  
Panitan Lukkunaprasit, Thailand  
Gregory A. MacRae, New Zealand  
Stephen A. Mahin, USA  
Hideo Matsutomi, Japan  
Mitsumasa Midorikawa, Japan  
Masami Miyajima, Japan  
Jack P. Moehle, USA  
Masaki Morishita, Japan  
Masato Motosaka, Japan  
Shoichi Nakai, Japan  
Yoshiaki Nakano, Japan  
Masayoshi Nakashima, Japan  
Isao Nishiyama, Japan  
Aydan Omer, Japan  
Andreas Oreta, Philippines  
Shunsuke Otani, Japan  
Stefano Pampanin, New Zealand  
Kyriazis D. Pitolakis, Greece  
Nigel Priestley, New Zealand  
Andrei M. Reinhorn, USA  
Anat Ruangrassamee, Thailand  
Saiid Saiidi, USA  
Kenji Satake, Japan  
Charles Scawthorn, USA  
Ai Sekizawa, Japan  
Kunihiko Shimazaki, Japan  
Masanori Shintani, Japan  
Hitoshi Shiohara, Japan  
Masaki Shiratori, Japan  
Akira Sone, Japan

Takahiro Sugano, Japan  
Yuping Sun, China  
Kohei Suzuki, Japan  
Keiichi Tadokoro, Japan  
Hajime Takada, Japan  
Yoshikazu Takahashi, Japan  
Keiichi Tamura, Japan  
Reiji Tanaka, Japan  
Jyunichi Tohma, Japan  
Koji Tokimatsu, Japan  
Takashi Tomita, Japan  
Ikuo Towhata, Japan  
Keh Chyuan Tsai, Taiwan  
Yoshimichi Tsukamoto, Japan

Shigeki Unjoh, Japan  
Ramon Verdugo, Chile  
Kazue Wakamatsu, Japan  
John Wallace, USA  
Lanmin Wang, China  
Fumio Yamazaki, Japan  
Mark Yashinsky, USA  
Susumu Yasuda, Japan  
Lieping Ye, China  
W. Phillip Yen, USA  
Solomon Yim, USA  
Fulin Zhou, China  
Askar Zhusbekov, Kazakhstan

## **SYMPOSIUM CHAIRMAN**

Kazuhiko Kawashima  
President, Japan Association for Earthquake Engineering  
Professor, Department of Civil Engineering  
Tokyo Institute of Technology  
Tel +81-3-5734-2922  
E-mail kawashima.k.ae@m.titech.ac.jp

## **ORGANIZING COMMITTEE MEMBERS**

Kazuhiko Kawashima (Chairman)  
Hitoshi Shiohara (Secretary)  
Osamu Furuya  
Hisahiro Hiraishi  
Teruyuki Kato  
Takashi Kiyota  
Kenji Kosa  
Hiroshi Matsuzaki  
Izumi Nakamura  
Yoshifumi Ohmiya  
Yoshikazu Takahashi  
Takashi Tomita  
Ikuo Towhata  
Yoshimichi Tsukamoto  
Shigeki Unjoh  
Susumu Yasuda  
Kazue Wakamatsu

## VENUE

### **Kenchiku-Kaikan** (Architectural Institute of Japan Building)

Address: 26-20 Shiba 5, Minato-ku, Tokyo, Japan, Zip code: 108-8414

and

### **Senbai Building**

Address: 26-30 Shiba 5, Minato-ku, Tokyo, Japan, Zip code: 108-8414

### **Access**

4 minute walk from JR Tamachi Station, and Mita Station of Metro of Mita Line or Asakusa Line

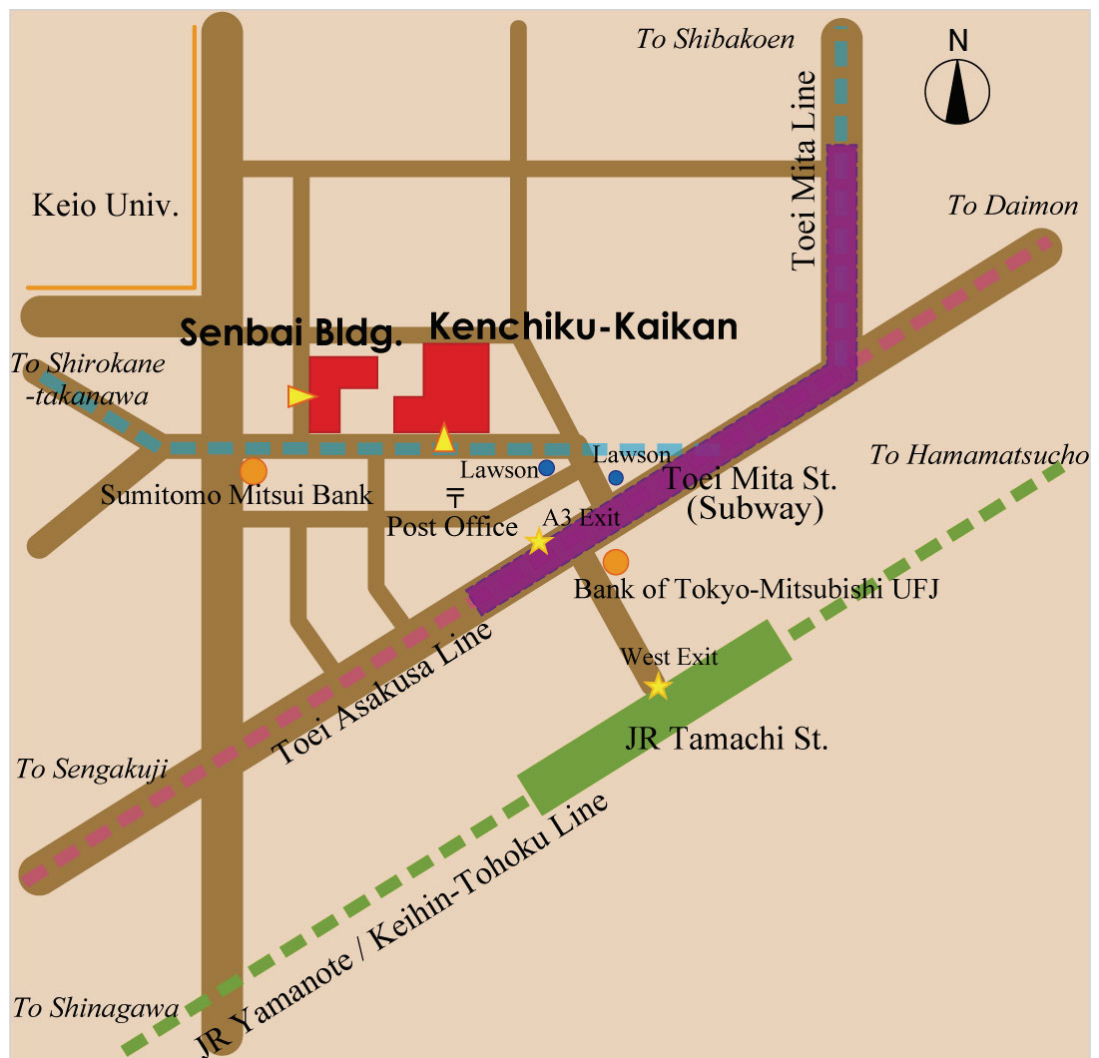

# HALLS AND ROOMS FOR PRESENTATIONS

## Hall A, Room A, Room B and Room C

Kenchiku-kaikan Building.

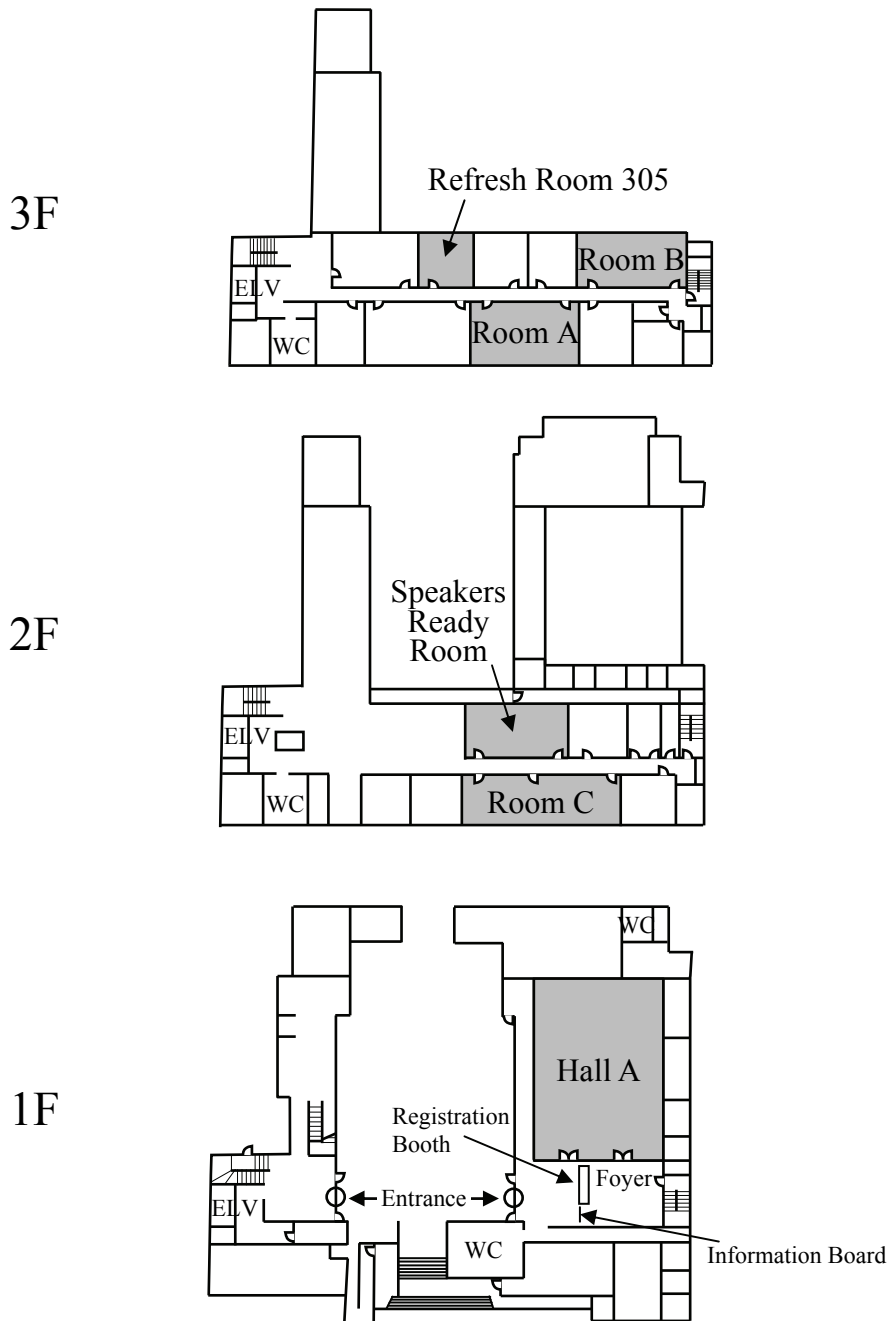

**Hall B**

8th floor of Senbai Building.

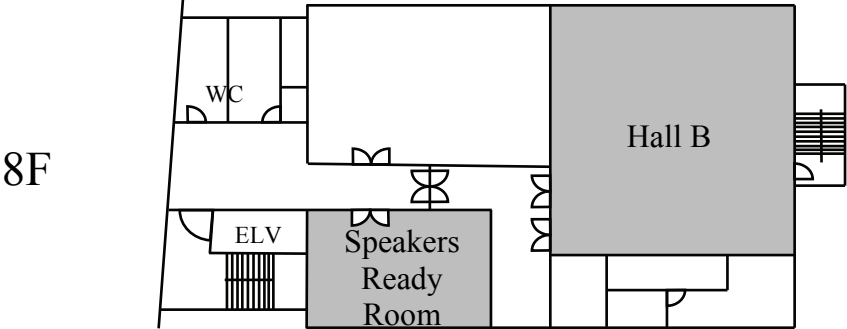



## **GENERAL INFORMATION**

### **OFFICIAL LANGUAGE**

The official language of the Symposium is English. All presentations and discussions must be conducted in English.

### **REGISTRATION**

Registration is required for all speakers and participants. Registration booth is open at the Main Hall Foyer during the following hours:

March 3, Saturday	8:30-20:00
March 4, Sunday	8:30-19:50

### **FOR SPEAKERS**

- Nineteen minutes is allocated for a regular presentation. Discussions follow after all presentations are completed.
- Forty minutes is allocated for a key note presentation followed by approximately five minutes discussions.
- A PC (Windows) is provided at each session room. It is suggested to bring a memory so that speakers use this PC for saving time for connection. However speakers can use your own PC if needed.

### **INFORMATION BOARD**

Any change of the Symposium will be posted on an Information Board at the Registration Booth

### **SPEAKER READY ROOM**

A speaker ready room (a room in front of Room C, second floor) is available to speakers.

### **WELCOME RECEPTION WITH LIGHT BUFFET**

19:00-20:00, March 3, Saturday  
Hall-A Foyer, 1st Floor, Kenchiku-kaikan Building

### **NO SMOKING, NO FOOD AND NO DRINKS**

Smoking is prohibited at the entire space in Kenchiku-kaikan and Senbai building. Food and drinks are also prohibited at the entire space of Kenchiku-kaikan and Senbai Building except Hall-A Foyer.

## TECHNICAL SITE VISITS

Pre-registration is required for the technical site visits by February 1, 2012 for Groups A, B and C, and January 18, 2012 for Group D. For entry to the nuclear power station (Group D), participants must submit personal information including age, address, ID and the size of boots and working wear in advance of the tour.

### **Tour A: Geotechnical Group (Maximum 50 persons)**

Earth dam failure (Fujinuma Reservoir), failure of earthfills reclaimed for residential area developments (Shiroishi & Sendai), tsunami (Ishinomaki and Onagawa), failure of river dykes (Eaigawa River), soil liquefaction (Urayasu)

### **Tour B: Building Group (Maximum 50 persons)**

Damage of Tohoku University (Sendai), damage of buildings (Miyagi-ken and Iwate-ken) and tsunami damage of buildings (Shizugawa and Rikuzen-Takada)

### **Tour C: Civil Infrastructure Group (Maximum 50 persons)**

Ground motion- and tsunami-induced damage of roads, railways and ports in north Miyagi-ken and south Iwate-ken along the Pacific coast, damage of lifeline facilities in Sendai and Ishinomaki

### **Tour D: Nuclear Power Station Group (maximum 30 persons)**

Damage in Sendai city, tsunami-induced damage in Ishinomaki and Onagawa. Visit to Onagawa Nuclear Power Station.

## KEYNOTE SPEAKERS

Ian M. Arbon, Institution of Mechanical Engineers, UK  
Akihiko Hokugo, Professor, Kobe University, Japan  
Fumihiko Imamura, Professor, Tohoku University, Japan  
Kojiro Irikura, Professor, Aichi Institute of Technology, Japan  
Kenji Ishihara, Professor, Chuo University, Japan  
Toshimi Kabeyasawa, University of Tokyo, Japan  
Hiroyuki Kameda, Professor Emeritus, Kyoto University, Japan  
Kazuhiko Kawashima, Professor, Tokyo Institute of Technology, Japan  
Kazuki Koketsu, Professor, University of Tokyo, Japan  
Mikio Koshihara, Professor, University of Tokyo, Japan  
Stephen A. Mahin, Professor, University of California, Berkeley, USA  
Masato Motosaka, Professor, Tohoku University, Japan  
Hideki Nariai, Professor Emeritus, Tsukuba University, Japan  
Masaki Shiratori, Professor, Yokohama National University, Japan

## PROGRAM OVERVIEW

### March 3, Saturday

Time	Hall A	Room A	Room B	Room C	Hall B
9:00-12:00	HA0: Keynote (1)				
12:00-12:50	Break				
12:50-15:05	HA1: Keynote (2)	A1: Recent Earthquakes (1)	B1: Damage of Geotechnical Structures	C1: Damage of Buildings (1)	HB1: Tsunami (1)
15:05-15:20	Break				
15:20-17:10	HA2: Damage of Buildings (2)	A2: Damage of Machineries and Power Generation Facilities	B2: Soil Liquefaction (1)	C2: Evacuation, Repair and Restoration (1)	HB2: Tsunami (2)
17:10-17:25	Break				
17:25-18:55	HA3: Damage of Buildings (3)	A3: Recent Earthquakes (2)	B3: Soil Liquefaction (2)	C3: Evacuation, Repair and Restoration (2)	HB3: Tsunami (3)
19:00-20:00	Welcome Reception with Light Buffet				

### March 4, Sunday

Time	Hall A	Room A	Room B	Room C	Hall B
9:00-10:30	HA4: Keynote (3)	A4: Recent Earthquakes (3)	B4: Fault Mechanism (1)	C4: Damage of Lifeline Facilities (1)	HB4: Tsunami (4)
10:30-10:45	Break				
10:45-12:15	HA5: Damage of Buildings (4)	A5: Damage of Nuclear Power Stations	B5: Fault Mechanism (2)	C5: Damage of Lifeline Facilities (2)	HB5: Tsunami (5)
12:15-13:05	Break				
13:05-14:35	HA6: Keynote (4)	A6: Recommendations for Future Earthquake Risk Mitigation	B6: Fire	C6: Damage of Buildings (5)	HB6: Ground Motions (1)
14:35-14:50	Break				
14:50-17:05	HA7: Keynote (5)	A7: Recent Earthquakes (4)	B7: Soil Liquefaction (3)	C7: Damage of Transportation Facilities (1)	HB7: Ground Motions (2)
17:05-17:20	Break				
17:20-19:50	HA8: Damage of Buildings (6)	A8: Evacuation, Repair and Restoration (3)	B8: Soil Liquefaction (4)	C8: Damage of Transportation Facilities (2)	HB8: Ground Motions (3)

## AUTHORS INDEX

Tauqir Ahmed	A4	Yao Cui	HA8
Koji Aizawa	HA2	Mine B. Demircioglu	A7
Tomofusa Akita	HA5	Hiroshi Dohi	HA2
Mitsuyoshi Akiyama	C7	Rithika Dulam	C3
Tomoaki Akiyama	HA3	Katsumi Ebisawa	A5
Hamood A. Al-Washali	HA3, HA8	John M. Eidinger	A4
Suppar Anawat	HA0	Joji Ejiri	B7
Shoichi Ando	C3	Kenneth J. Elwood	HA3
Emmanuel Andreidakis	HB1	Hidenori Endoh	B2
Tadashi Annaka	HB5	Mustafa Erdik	A7
Shigeki Aoki	HB4	Chikako Eto	B8
Takayuki Aoki	HB7	Piyawat Foytong	HB2
Takayuki Aoyagi	A2	Koji Fujima	HB2
Hiroshi Arai	HA5	Kohei Fujita	C1, HB3
Masayuki Arai	HB6	Makoto Fujiu	C2, C8
Kazuhiro Araki	B3	Hiroyuki Fujiwara	B3, HB8
Tatsuhiko Arata	HA2	Wataru Fukatani	C5
Ian M. Arbon	HA6	Hiroshi Fukuyama	HB2
Hiroshi Asahara	HB7	Takahisa Fukuyama	B7
Tatsuya Asai	HB2	Hideki Funahara	B7
Toru Asakura	B8	Toshihiko Furui	B1
Tomohiro Atsumi	HB6	Satoshi Furukawa	B1
Ady Aviram	A1	Mikio Futaki	HA5
Omer Aydan	A7, B1	Nicolas Giron	C1
Ian Billings	A4	Hideaki Goto	B4
Erik Bishop	HA8	Hiroyuki Goto	HB6, HB8
Yehuda Bock	HB4	Wataru Goto	HA2
Patricio Bonelli	A1	Yozo Goto	C2
Fabian Bonilla	HB7	Yuji Haga	HB2
Ruben Boroscchek	A1	Masanori Hamada	C3
Ross W. Boulanger	B2	Toshikazu Hanazato	HA8
Brendon Bradley	B8	Nobusuke Hasegawa	B3
Paul Brallier	HA8	Yoshiya Hata	HB8
Jonathan Bray	B5	Takashi Hayakawa	HB7
Jeremy D. Bricker	C8	Yutaka Hayashi	HB5
Ian Buckle	C7	Duncan Henderson	B8
Fei Cai	B7	Greg Hess	HA8
Lyle Carden	HB2	Yo Hibino	A7
Jorge F. Carvalho	A1	Takenori Hida	C1
Mehmed Celebi	A7, C1	Tomohiro Higashide	C4
Dyi-Wei Chang	A3	Shinichi Higuchi	B7
Kuo-Chun Chang	A3	Katsuichirou Hijikata	A2, HB6
Shuenn-Yih Chang	HA8	Mitsumasa Hirano	A5
Nicholas Charman	A4	U Hiroi	B6
Bo-Long Chen	A3	Yoshiaki Hisada	HA2
Chien-Chou Chen	A3	Akihiko Hokugo	A8, HA1
Chun-Chi Chen	B7	Muneo Hori	C3, HB3
Tien-Chien Chen	A3	Nobuyuki Horie	C5
Kwok Fai Cheung	HB1	Haruo Horikawa	B5
King Chin	HA8	Daishi Horiuchi	B4
Gary Chock	HB2	Jun-ichi Hoshikuma	C7
Victor Contreras	A1	Hsiao-Yuan Hsu	A3
Brendan Crowell	HB4	Shuai Huang	A7
Misko Cubrinovski	B8	Yuli Huang	A1

Hsiao-Hui Hung	A3	Ryosuke Kato	B1
Agussalim Bin Husen	C2	Akio Katsumata	HB4
Masayuki Hyodo	B1	Kota Katsumata	B2
Adnan Ibrahimbegovic	HB3	Shouhei Kawabe	B3
Ichiro Ichihashi	A2	Naohito Kawai	HA7
Tsuyoshi Ichimura	C3, HB3	Katsuya Kawakami	HA8
Toshikatsu Ichinose	C6, HA8	Kiichiro Kawamura	B5
Hitoshi Ieda	A6	Kota Kawasaki	A8
Hirokazu Iemura	C, HB3	Hiroshi Kawase	HB7
Masanori Iiba	C1, HA5	Kazuhiko Kawashima	C7, C8, HA1
Yoshihisa Iio	B4	Zaheer A. Kazmi	A4, B1, B5
Masayoshi Iizuka	C6	Chinami Keino	B8
Takaaki Ikeda	HB8	Dominic Kelly	A1
Yasutake Ikeda	B4	Yukari Kido	B4
Alper Ilki	A7	Hiroyoshi Kiku	B8
Toshio Imai	C4	Kenji Kikuchi	HA8
Fumihiko Imamura	HA0	Rikiro Kikuchi	A2
Satoru Inaba	C1	Sayuri Kimoto	B1
Takuya Inada	HA1	Masataka Kinoshita	B5
Eiichi Inai	C6	Kazuhiro Kitayama	C6
Masayuki Inatani	HB6	Takashi Kiyota	B1, B8
Wataru Inomata	C5	Masashi Kobayashi	C7
Shusaku Inoue	HB5	Kazuya Koga	HA8
Yoshio Inoue	C6	Masayuki Kohiyama	B8, C1
Muhammad Irfan	A4	Takeshi Koike	C4
Kojiro Irikura	HA0, HB4	Kazuki Koketsu	HA0
Tadayoshi Ishibashi	C7	Takaji Kokusho	B3, B7
Kenji Ishihara	B7, HA1	Kazuo Konagai	A7, B1, B5, B8, HB8
Masanori Ishihara	B7	Kenji Kosa	C8
Keisuke Ishikawa	B8	Onur Kose	A7
Ritsuko Ishikawa	C1	Mikio Koshihara	HA7
Hiroki Ishino	HB7	Irene Kostaki	HB1
Kazuya Ishitsuka	B8	Shin Koyama	C1, HA5
Sadayuki Ishizaki	B7	Tomohiro Kubo	HA2
Hiroshi Isoda	HA7	Halil Kumsar	A7
Dinar C. Istiyanto	HB3	Marianne Kupfer	A1
Fumiki Ito	B7	Susumu Kurahashi	HA0
Yoshihiro Ito	B5	Masayuki Kuroki	HA8
Masahiro Iwasaki	HB6	Masamitsu Kuse	B4
Nobuyuki Izumi	HA5	Koichi Kusunoki	A7, C6
Noriaki Izumi	B4	Yasuko Kuwata	C4
Xuan Jiang	A3	Alexis Kwasinski	C5
Toshimi Kabeyasawa	C6, HA7	Hiroyuki Kyokawa	B1, B8
Weng Yuen Kam	HA3	Rene Lagos	A1
Kazuya Kamataki	C6	Maddegedara Lalith	C3
Hiroyuki Kameda	A5, HA4	Wei F. Lee	B7
Yaver Kamer	A7	Zheng-Kuan Lee	A3
Makoto Kamiyama	B4	Efthymis Lekkas	HB1
Toshiya Kanamatsu	B5	Jianzhong Li	C8
Masahiro Kaneko	HB8	Zong-Lian Li	A3
Osamu Kaneko	HA5	Wen-I Liao	HA8
Toshimichi Kaneto	HB5	Meei-Ling Lin	A3
Eleni Kapourani	HB1	Yeng-Ji Lin	A3
Kazuhiko Kasai	HA2	Doug Lindquist	HA8
Takafumi Kasaya	B5	Kuang-Yen Liu	A3
Toshihide Kashima	C1, HA5	Zhiwei Liu	HA5
Masayuki Kashiwayanagi	HB7	Masaki Maeda	HA3, HA8
Christophe Kassiotis	HB3	Takahiro Maeda	B3
Toshihiko Katagiri	B1, B8	Joe Maffei	A1
Shojiro Kataoka	HB8	Stephen Mahin	HA0
Daisuke Kato	C6	Hidenari Makino	HB1

Lee Marsh	C7	Isao Nishiyama	HA2, HB2
Florent De Martin	HB7	Azusa Nishizawa	B4
Mitsugu Mashimo	A2	Shohei Noda	B1
Arata Masuda	A2	Tatsuki Noda	A2
Manabu Matsuhashi	C5	Nobuoto Nojima	C5
Hiroyuki Matsumoto	HB5	Yuki Norito	C5
Toshifumi Matsuoka	B5, B8	Atsushi Nozu	HB8
Shinichi Matsushima	HB7	Muneyoshi Numada	A7, C2, C8
Hiroshi Matsuzaki	C7	Yumiko Ogura	HB6
Toru Matsuzawa	B4	Lian Ching Oh	A4
Hermann G. Matthies	HB3	Miho Ohara	A8, C2, C8
Kimiro Meguro	A8, C2	Tatsuo Ohmachi	HB5
Diego Melgar	HB4	Yoji Ohnishi	C4
Mitsumasa Midorikawa	HA2	Susumu Ohno	HA5, HB8
Saburoh Midorikawa	HB6	Tsuneo Ohsumi	HB7
Noriyuki Mita	HA8	Fusao Oka	B1
Kazuya Mitsuji	HA5, HB8	Tsuneo Okada	HB2
Hiroyuki Miura	HB6	Taro Okamoto	HB7
Goro Miwada	C1	Izuru Okawa	C1, HA5, HB2
Masakatsu Miyajima	C4, C8	Toshio Okazumi	HB3
Ken Miyakoshi	HB4	Keisuke Okihara	HA3
Hiroshi Miyano	A5	Yasuo Okuda	HB2
Keita Mizuno	C7	Michael J. Olsen	HB1
Koichiro Mizuno	C7	Atsuo Onoue	B7
Hiroyuki Mizutani	HB6	Terumi Oohashi	B2
Jack Moehle	HA3	Rolando Orense	B1
Eric Monzon	C7	Mitsutaka Oshima	HB7
Hitoshi Morikawa	HB6	Masaaki Ouchi	A8
Nobuyuki Morikawa	HB8	Masaaki Ozaki	C5
Toshiya Motohi	HA2	Stefano Pampanin	HA3
Masato Motosaka	HA5, HA7, HB8	Anatoly Petukhin	HB4
Kouki Murakami	B1	Mark Pierepiekarz	HA8
Masahiro Murakami	HA2	Mulyo H. Pradono	C2, HB3
Satoshi Murakami	B2	Wenchuan Pu	HA2
Satoshi Naba	A2, C4	Santiago Pujol	A1, HA8
Masayuki Nagano	C1	Fuqiang Qi	A7
Toshiaki Nagao	B7	Jose I. Restrepo	A1, HB4
Yohta Nagao	B7	Ian Robertson	HB2
Fumiaki Nagashima	HB7	Mario E. Rodriguez	HA8
Shigeto Nagashima	HA2	Anat Ruangrassamee	HB2
Shigeru Nagata	C4	M. Saiid Saiidi	C8
Atsushi Nagaya	HA8	Kenji Saito	HA2
Shoichi Nakai	B8, HA5, HB7	Taiki Saito	HA8
Hiroataka Nakajima	B2	Junichi Sakai	C7
Kosuke Nakajima	C1	Noriaki Sakamoto	B6
Miyoko Nakajima	B7	Toshiaki Sakurai	B1
Mitsuru Nakamura	C1	Umair Saleem	A4
Susumu Nakamura	HB8	Dominga Sanchez	HB4
Takao Nakamura	A5	Francisco J. Sanchez-Sesma	HB7
Takeshi Nakamura	HB7	Katsunori Sasaki	B6
Tomoharu Nakamura	A8, B1	Takahiro Sasaki	C6
Yukiko Nakamura	HA5	Tetsuya Sasaki	B7
Yoshiaki Nakano	HB2	Toshimi Satoh	HB7
Masayoshi Nakashima	A6	Sumio Sawada	HB6
Takashi Nakata	B4	Charles Scawthorn	B6
Akihiko Nakayama	C8	Haruko Sekiguchi	B5
Hideki Nariai	HA4	Toru Sekiguchi	B8, HB7
Haruki Nishi	B6	Ai Sekizawa	B6
Masayoshi Nishikawa	B7	Shigeki Senna	B3
Isao Nishimura	HB6	Karin Sesetyan	A7
Tomoaki Nishino	A8, HA1	Akenori Shibata	C2

Akihiro Shibayama	HB8	Takehiko Terada	HA2
Kenichi Shibuya	B8	Masaomi Teshigawara	C6
Yuko Shimada	HA5	Cigdem Tetik	B5
Hideaki Shimizu	C8	Ken-ichi Tokida	B1, HB1
Jun Shindo	HA2	Kohji Tokimatsu	B2
Kiyoshi Shingu	HB1	Shinji Tokita	C6
Hitoshi Shiohara	HA3	Satoshi Tokue	HB6
Shigeaki Shiotani	HB1	Takashi Tomita	HB1
Masaki Shiratori	HA6	Takashi Torigoe	B7
Gaku Shoji	A2, A8, B1, C4	Ikuo Towhata	A6, B8
Jonathan Siu	HA8	Kozo Toyota	HA2
Akira Sone	A2	Peter S. Tsai	B1
Bo Song	A7	Shin-ichi Tsuburaya	A8
Ashley Streig	B5	Takahiro Tsuchimoto	HA7
Tadashi Sugano	HB2	Takeshi Tsuji	B5, B8
Megumi Sugimoto	C2	Yoshimichi Tsukamoto	B3
Yoshifumi Sugimura	HA2	Takuya Tsukiji	A2, C4
Katsutoshi Sugioka	A2	Hiroaki Tushima	HB5
Masato Sugito	B4	Ying-Lieh Tu	C1
Yu-Chi Sung	A3, HA8	Hiroshi Ueno	HB4
Shota Suyama	B8	Resat Ulusay	A7
Kazuki Suzuki	HA3	Ergin Ulutas	HB4
Mikio Suzuki	HA2	Shigeeki Unjoh	A1, C8
Yasuhiro Suzuki	B4	Ramon Verdugo	B3
David Swanson	HA8	Isaac Villanova	HA8
Syamsidik	HB3	Akira Wada	HA2
Yu Tabayashi	B2	Kazue Wakamatsu	B2
Aino Tachibana	B1	John Wallace	HA3
Motohide Tada	HA2	Zhen-Yu Wang	A3
Yuichi Taguchi	B8	Hidekazu Watanabe	A7
Kazuyuki Takada	C8	Kazuhiko Watanabe	HA3
Tsuyoshi Takada	A5	Keisuke Watanabe	C1
Dai Takahashi	A2	Mitsuhisa Watanabe	B4
Hidenori Takahashi	B2	Lalith Wijerathne	HB3
Kanako Takahashi	HA3	Michael Willford	A1
Kazunori Takahashi	A8, B1	Tom Xia	HA8
Makoto Takahashi	A2	Takahiro Yabuguchi	C4
Ryosuke Takahashi	B3	Tokiyoshi Yamada	B6
Susumu Takahashi	HA8	Masayuki Yamanaka	C1
Toru Takahashi	HA5	Tetsuo Yamashita	HA2
Yoshikazu Takahashi	C2, C7, HB8	Yoshiki Yamazaki	HB1
Naotaka Takamatsu	A5	Ken Yanagisawa	HB5
Makoto Takao	HB5	George C. Yao	C1
Syuhei Takeda	C8	Mark Yashinsky	C8
Hiroshi Takenaka	HB7	Susumu Yasuda	B8
Izuru Takewaki	C1	Kazuya Yasuhara	B2
Makoto Tamura	B2	Wen-Huei Yen	C7
Atsushi Tanaka	A8	Solomon C. Yim	HB1
Seizo Tanaka	C3, HB3	Hsiao-Yuan Yin	A3
Shigenobu Tanaka	HB3	Shih-Hsun Yin	HA8
Takeyoshi Tanaka	A8	Gyeong-Seon Yoem	HB1
Alex K. Tang	C5	Takashi Yokota	HB4
Tomoyuki Tani	HB5	Toshihiro Yokota	C5
Ryusuke Tanimoto	HB1	Kumiko Yoneda	B7
Hisataka Tano	B1	Kunikazu Yoshida	HB4
Mucip Tapan	A7	Minako Yoshida	C1
Akira Tasai	A7, C6	Osamu Yoshida	C1
Tomokazu Tateno	HB2	Yasuhiro Yoshida	HB4, HB5
Fumio Tatsuoka	A6	Masayuki Yoshimi	B5
Andrew W. Taylor	HA2, HA8	Shinta Yoshitomi	C1
Karl Telleen	A1	Guangren Yu	HB2



Nam-Yi Yun  
Guangfeng Zhang  
Hua Zhang

C3  
C7  
C8

Xin-Rui Zhang  
Dapeng Zhao

HB6  
B5

# DAILY TECHNICAL PROGRAMS

**March 3, Saturday**

## HALL A

### HA0 9:00-12:00 KEYNOTE PRESENTATIONS (1)

Moderator: Teruyuki Kato

**Kazuki Koketsu** (University of Tokyo)

Seismological and Geodetic Aspects of the 2011 Tohoku Earthquake and  
Great East Japan Earthquake Disaster ..... 1

Moderator: Saburoh Midorikawa

**Kojiro Irikura** (Aichi Institute of Technology) and Susumu Kurahashi

Strong Ground Motions during the 2011 Pacific Coast Off Tohoku, Japan Earthquake ..... 2

Moderator: Takashi Tomita

**Fumihiko Imamura** (Tohoku University) and Suppasr Anawat

Damage due to the 2011 Tohoku Earthquake Tsunami and Its Lessons for Future Mitigation ..... 3

Moderator: Kazuhiko Kawashima

**Stephen Mahin** (University of California, Berkeley)

Lessons from Recent Earthquakes: The Need for More Resilient Cities ..... 4

### HA1 12:50-15:05 KEYNOTE PRESENTATIONS (2)

Moderator: Kenichi Ikeda

**Akihiko Hokugo** (Kobe University), Tomoaki Nishino and Takuya Inada

Damage and Effects Caused by Tsunami Fires: Fire Spread, Fire Fighting and Evacuation ..... 5

Moderator: Susumu Yasuda

**Kenji Ishihara** (Chuo University)

Liquefaction in Tokyo Bay and Kanto Regions in the 2011 Great East Japan Earthquake ..... 6

Moderator: Ian Buckle

**Kazuhiko Kawashima** (Tokyo Institute of Technology)

Damage of Bridges due to the 2011 Great East Japan Earthquake ..... 7

### HA2 15:20-17:10 DAMAGE OF BUILDINGS (2)

Moderators: Mitsumasa Midorikawa and Andrew W. Taylor

**Mitsumasa Midorikawa** (Hokkaido University), Isao Nishiyama, Motohide Tada and Takehiko Terada

Earthquake and Tsunami Damage on Steel Buildings Caused by the 2011 Tohoku Japan Earthquake ..... 8

**Wataru Goto** (NTT Facilities, Inc.) Toshiya Motohi, Yoshifumi Sugimura, Shigeto Nagashima,  
Kozo Toyota, Mikio Suzuki, Hiroshi Dohi and Kenji Saito

Evaluation of Earthquake Response of High-rise Building with Dampers  
in Sendai during the 2011 Off the Pacific Coast of Tohoku Earthquake ..... 9

<b>Andrew W. Taylor</b> (KPF Consulting Engineers) Response Control Systems in the United States and Lessons Learned from the Tohoku Earthquake .....	10
<b>Kazuhiko Kasai</b> (Tokyo Institute of Technology), Wenchuan Pu and Akira Wada Responses of Controlled Tall Buildings in Tokyo Subjected to the Great East Japan Earthquake .....	11
<b>Yoshiaki Hisada</b> (Kogakuin University), Tetsuo Yamashita, Masahiro Murakami, Tomohiro Kubo, Jun Shindo, Koji Aizawa and Tatsuhiro Arata Seismic Response and Damage of High-rise Buildings in Tokyo, Japan, during the Great East Japan Earthquake .....	12

### **HA3 17:25-18:55 DAMAGE OF BUILDINGS (3)**

Moderators: Hitoshi Shiohara and John W. Wallace

<b>Masaki Maeda</b> (Tohoku University), Hamood A. Al-Washali, Kanako Takahashi and Kazuki Suzuki Damage to Reinforced Concrete School Buildings in Miyagi after the 2011 Great East Japan Earthquake .....	13
<b>John Wallace</b> (University of California, Los Angeles) and Jack Moehle Behavior and Design of Structural Walls – Lessons from Recent Laboratory Tests & Earthquakes .....	14
<b>Hitoshi Shiohara</b> (University of Tokyo), Tomoaki Akiyama, Kazuhiko Watanabe and Keisuke Okihara Seismic Damage of a Nine-story RC Residential Building in Sendai Designed by Old Seismic Codes .....	15
<b>Kenneth J. Elwood</b> (University of British Columbia), Stefano Pampanin and Weng Yuen Kam 22 February 2011 Christchurch Earthquake and Implications for the Design of Concrete Structures .....	16

## **ROOM A**

### **A1 12:50-15:05 RECENT EARTHQUAKES (1)**

Moderators: Isao Nishiyama and Patricio Bonelli

<b>Ruben Boroschek</b> (University of Chile) and Victor Contreras Strong Ground Motion from the 2010 Mw 8.8 Maule Chile Earthquake and Attenuation Relations for Chilean Subduction Zone Interface Earthquakes .....	17
<b>Santiago Pujol</b> (Purdue University) An Initiative to Preserve Information about the 2010 Maule, Chile, Earthquake: Following the Roadmap Laid out by Shiga and Shibata .....	18
<b>Rene Lagos</b> (René Lagos Engineers) and Marianne Kupfer Performance of High Rise Buildings under the February 27th 2010 Chilean Earthquake .....	19
<b>Karl Telleen</b> (Rutherford & Chekene), Joe Maffei, Michael Willford, Ady Aviram, Yuli Huang, Dominic Kelly and Patricio Bonelli Lessons for Concrete Wall Design from the 2010 Maule Chile Earthquake .....	20
<b>Patricio Bonelli</b> (Santa Maria University), Jose I. Restrepo, Ruben Boroschek and Jorge F. Carvallo The 2010 Great Chile Earthquake – Changes to Design Codes .....	21
<b>Shigeki Unjoh</b> (National Institute for Land and Infrastructure Management) Repair and Retrofit of Bridges Damaged by the 2010 Chile Maule Earthquake .....	22

## **A2 15:20-17:10 DAMAGE OF MACHINERIES AND POWER GENERATION FACILITIES**

Moderators: Akira Sone and Osamu Furuya

- Katsutoshi Sugioka** (Tokyo Electric Power Company), Rikiro Kikuchi and Katsuichirou Hijikata  
The Behavior of the Reactor Building at Fukushima Dai-ichi Nuclear Power Plant  
during the Great East Japan Earthquake ..... 23
- Katsuichirou Hijikata** (Tokyo Electric Power Company), Makoto Takahashi,  
Takayuki Aoyagi and Mitsugu Mashimo  
Behavior of a Base-isolated Building at Fukushima Dai-ichi Nuclear Power Plant  
during the Great East Japan Earthquake ..... 24
- Gaku Shoji, **Dai Takahashi** (University of Tsukuba), Takuya Tsukiji and Satoshi Naba  
Damage Assessment on Electric Power Failures during the 2011  
Off the Pacific Coast of Tohoku Earthquake ..... 25
- Ichiro Ichihashi, **Akira Sone** (Kyoto Institute of Technology), Arata Masuda and Tatsuki Noda  
A Study on Maximum Responses on Elasto-plastic  
Structure Excited by Synthesized Ground Motions ..... 26

## **A3 17:25-18:55 RECENT EARTHQUAKES (2)**

Moderators: Yoshiaki Nakano and Kazuo Konagai

- Tien-Chien Chen** (National Pingtung University of Science and Technology),  
Hsiao-Yuan Yin, Zhen-Yu Wang, Xuan Jiang, Bo-Long Chen and Zong-Lian Li  
Initiation of Hillslope Debris Flow Affected by Chi-Chi Earthquake, Taiwan ..... 27
- Meei-Ling Lin** (National Taiwan University), Yeng-Ji Lin and Hsiao-Yuan Hsu  
Case Studies on the Sliding Behaviors of the Tsao-Ling Dip-slope  
Landslides Induced by Earthquakes ..... 28
- Kuo-Chun Chang** (National Taiwan University), Zheng-Kuan Lee and Chien-Chou Chen  
Structural Assessment of a Repaired Cable Bridge Damaged in 1999 Chi-Chi Earthquake ..... 29
- Yu-Chi Sung** (National Taipei University of Technology), Kuo-Chun Chang, Dyi-Wei Chang,  
Hsiao-Hui Hung and Kuang-Yen Liu  
Damage Investigation and Seismic Retrofit of Bridges in Taiwan after 921 Chi-Chi Earthquake ..... 30

## **ROOM B**

### **B1 12:50-15:05 DAMAGE OF GEOTECHNICAL STRUCTURES**

Moderators: Omer Aydan and Masayuki Hyodo

- Fusao Oka** (Kyoto University), Peter S. Tsai, Sayuri Kimoto and Ryosuke Kato  
Numerical Analysis of Damage of River Embankment  
on Soft Soil Deposit due to Earthquakes with Long Duration Time ..... 31
- Masayuki Hyodo** (Yamaguchi University), Rolando Orense, Shohei Noda,  
Satoshi Furukawa and Toshihiko Furui  
Mechanism of Slope Failures in Residential Land on Fill during  
the Great East Japan Earthquake ..... 32
- Kouki Murakami** (Osaka University), Ken-ichi Tokida and Aino Tachibana  
Simulation of Sliding Failure Occurred at Highway Embankment  
in 2011 Great East Japan Earthquake ..... 33

<b>Toshiaki Sakurai</b> (University of Tsukuba), Gaku Shoji, Kazunori Takahashi and Tomoharu Nakamura Damage Assessment on Road Structures due to Slope Failures in the 2011 Off the Pacific Coast of Tohoku Earthquake .....	34
<b>Hiroyuki Kyokawa</b> (University of Tokyo), Kazuo Konagai, Takashi Kiyota, Toshihiko Katagiri and Zaheer A. Kazmi LIDAR Measurement of the Breached Earth-fill Dam in the March 11th Great East Japan Earthquake .....	35
<b>Omer Aydan</b> (Tokai University), and Hisataka Tano The Damage to Abandoned Mines and Quarries by the Great East Japan Earthquake on March 11, 2011 .....	36

## **B2 15:20-17:10 SOIL LIQUEFACTION (1)**

Moderators: Takaji Kokusho and Misko Cubrinovski

<b>Ross W. Boulanger</b> (University of California, Davis) Liquefaction in the 2011 Great East Japan Earthquake: Lessons for U.S. Practice .....	37
<b>Kohji Tokimatsu</b> (Tokyo Institute of Technology) and Kota Katsumata Liquefaction-induced Damage to Buildings in Urayasu City during the 2011 Tohoku Pacific Earthquake .....	38
<b>Kazue Wakamatsu</b> (Kanto Gakuin University) Recurrent Liquefaction Induced by the 2011 Great East Japan Earthquake Compared with the 1987 Earthquake .....	39
<b>Hidenori Takahashi</b> (Ministry of Land, Infrastructure, Transport and Tourism), Terumi Oohashi and Hidenori Endoh Earthquake Damage Investigation of Gravity-type Quay Walls in Ibaraki Port .....	40
<b>Kazuya Yasuhara</b> (Ibaraki University), Makoto Tamura, Yu Tabayashi, Satoshi Murakami and Hirotaka Nakajima Residential Damage in Ibaraki during the Great Eastern Japan Earthquake .....	41

## **B3 17:25-18:55 SOIL LIQUEFACTION (2)**

Moderators: Kazue Wakamatsu and Wei F. Lee

<b>Ramon Verdugo</b> (CMGI Ltd.) Comparing Liquefaction Phenomena Observed during the 2010 Maule, Chile Earthquake and 2011 Great East Japan Earthquake .....	42
<b>Shigeki Senna</b> (National Research Institute for Earth Science and Disaster Prevention), Nobusuke Hasegawa, Takahiro Maeda and Hiroyuki Fujiwara Liquefaction Damage of the Tonegawa Basin Caused by the 2011 Off the Pacific Coast of Tohoku Earthquake .....	43
<b>Yoshimichi Tsukamoto</b> (Tokyo University of Science), Shouhei Kawabe, Takaji Kokusho and Kazuhiro Araki Soil Liquefaction Observed at Areas Located along the Lower Stream of Tonegawa River during 2011 Great East Japan Earthquake .....	44
<b>Shouhei Kawabe</b> (Tokyo University of Science), Yoshimichi Tsukamoto, Takaji Kokusho and Ryosuke Takahashi Soil Liquefaction Observed at Katori City Located along the Lower Stream of Tonegawa River during 2011 Great East Japan Earthquake .....	45

## ROOM C

### C1 12:50-15:05 DAMAGE OF BUILDINGS (1)

Moderators: Kazuhiko Kasai and Mustafa Erdik

- George C. Yao** (National Cheng Kung University) and Ying-Lieh Tu  
The Generation of Earthquake Damage Probability Curves for Building Facilities in Taiwan ..... 46
- Izuru Takewaki** (Kyoto University), Kohei Fujita and Shinta Yoshitomi  
Uncertainties of Long-period Ground Motion and Its Impact on Building Structural Design ..... 47
- Goro Miwada** (Obayashi Corporation), Osamu Yoshida, Ritsuko Ishikawa and Mitsuru Nakamura  
Observation Records of Base-isolated Buildings in Strong Motion Area  
during the 2011 Off the Pacific Coast of Tohoku Earthquake ..... 48
- Kosuke Nakajima** (Keio University), Nicolas Giron, Masayuki Kohiyama, Keisuke Watanabe,  
Minako Yoshida, Masayuki Yamanaka, Satoru Inaba and Osamu Yoshida  
Seismic Response Analysis of a Semi-active-controlled Base-isolated  
Building during the 2011 Great East Japan Earthquake ..... 49
- Masayuki Nagano** (Tokyo University of Science) and Takenori Hida  
Dynamic Response Characteristics of Super High-rise Residential Buildings  
in Kanto and Kansai Areas during the Great East Japan Earthquake ..... 50
- Izuru Okawa** (Building Research Institute), Toshihide Kashima, Shin Koyama,  
Masanori Iiba and Mehmet Celebi  
Summary of Recorded Building Responses during the 2011 Off the Pacific Coast  
of Tohoku Earthquake with Some Implications to Design Motions ..... 51

### C2 15:20-17:10 EVACUATION, REPAIR AND RESTORATION (1)

Moderators: Hirokazu Iemura and K. C. Chang

- Hirokazu Iemura** (Kinki Polytechnic College), Mulyo H. Pradono, Megumi Sugimoto,  
Yoshikazu Takahashi and Agussalim Bin Husen  
Tsunami Height Memorial Poles in Banda Aceh and Recommendations for Disaster Prevention ..... 52
- Yozo Goto** (University of Tokyo)  
Fact-finding about Evacuation from the Unexpectedly Large Tsunami ..... 53
- Makoto Fujii** (University of Tokyo), Muneyoshi Numada, Miho Ohara and Kimiro Meguro  
Development of Supporting System for Building Damage Assessment ..... 54
- Akenori Shibata** (Tohoku University)  
Importance of the Inherited Memories of Great Tsunami Disasters in Natural Disaster Reduction ..... 55

### C3 17:25-18:55 EVACUATION, REPAIR AND RESTORATION (2)

Moderators: Yozo Goto and Keiichi Tamura

- Shoichi Ando** (Building Research Institute)  
Policy Analysis on Building Regulations and the Recovery of Earthquake / Tsunami Affected Areas ..... 56
- Rithika Dulam** (University of Tokyo), Lalith Maddegedara, Muneo Hori,  
Tsuayoshi Ichimura and Seizo Tanaka  
A Study on Effectiveness of Using Officials for Reducing Pre-evacuation  
Time in a Large Area, based on Multi Agent Simulations ..... 57

<b>Nam-Yi Yun</b> (Waseda University) and Masanori Hamada A Comparative Study on Human Impacts Caused by the 2011 Great East Japan Earthquake and Disaster Mitigation .....	58
---	----

## HALL B

### HB1 12:50-15:05 TSUNAMI (1)

Moderators: Yoshiaki Nakano and Gary Chock

<b>Solomon C. Yim</b> (Oregon State University), Kwok Fai Cheung, Michael J. Olsen and Yoshiki Yamazaki Tohoku Tsunami Survey, Modeling and Probabilistic Load Estimation Applications .....	59
---	----

<b>Kiyoshi Shingu</b> (Nihon University) Some Considerations based on Observations of Disaster-stricken Areas in Miyagi, Iwate and Aomori Prefectures after the Great Earthquake and the Island of Okushiri .....	60
---	----

<b>Takashi Tomita</b> (Port and Airport Research Institute) and Gyeong-Seon Yoem Tsunami Damage in Ports by the 2011 off Pacific Coast of Tohoku Earthquake .....	61
--	----

<b>Ken-ichi Tokida</b> (Osaka University) and Ryusuke Tanimoto Lessons and Views on Hardware Countermeasures with Earth Banks against Tsunami Estimated in 2011 Great East Japan Earthquake .....	62
---	----

Shigeaki Shiotani and <b>Hidenari Makino</b> (Kobe University) Analysis of Ship Evacuation in Tsunami Using AIS Data .....	63
---	----

<b>Efthymis Lekkas</b> (National and Kapodistrian University of Athens), Emmanuel Andreadakis, Irene Kostaki and Eleni Kapourani A New Tsunami Intensity Scale Proposed after the Tsunami of 11 March 2011, Japan .....	64
---	----

### HB2 15:20-17:10 TSUNAMI (2)

Moderators: Ken-ichi Tokida and Solomon C. Yim

<b>Gary Chock</b> (Martin & Chock, Inc.), Ian Robertson, Lyle Carden and Guangren Yu Tohoku Tsunami-induced Building Damage Analysis Including the Contribution of Earthquake Resistant Design to Tsunami Resilience of Multi-story Buildings .....	65
---	----

<b>Isao Nishiyama</b> (National Institute for Land and Infrastructure Management), Izuru Okawa, Hiroshi Fukuyama and Yasuo Okuda Building Damage by the 2011 Tohoku Japan Earthquake and Coping Activities by NILIM and BRI Collaborated with the Administration .....	66
---	----

<b>Tatsuya Asai</b> (University of Tokyo), Yoshiaki Nakano, Tomokazu Tateno, Hiroshi Fukuyama, Koji Fujima, Yuji Haga, Tadashi Sugano and Tsuneo Okada Tsunami Load Evaluation based on Damage Observation after the 2011 Great East Japan Earthquake .....	67
--	----

<b>Anat Ruangrassamee</b> (Chulalongkorn University) and Piyawat Foytong Correlation Analysis of a Reinforced-concrete Building under Tsunami Loads and Effect of Masonry Infill Walls in Tsunami Resistance .....	68
--	----

### **HB3 17:25-18:55 TSUNAMI (3)**

Moderators: Takashi Tomita and Anat Ruangrassamee

<b>Kohei Fujita</b> (University of Tokyo), Tsuyoshi Ichimura, Muneo Hori, Lalith Wijerathne and Seizo Tanaka Application of Seamless Simulation of Seismic Response Analysis and High Resolution Tsunami Simulation to Coastal Area of Sendai .....	69
<b>Adnan Ibrahimbegovic</b> (Ecole Normale Supérieure, French), Christophe Kassiotis and Hermann G. Matthies Tsunami Impact on Coastal Structures: Partitioned Solution Procedure for Fluid-structure Interaction with Free-surface Flow .....	70
<b>Dinar C. Istiyanto</b> (Public Works Research Institute), Shigenobu Tanaka, Toshio Okazumi and Syamsidik Towards Better Mitigation of Tsunami Disaster in Indonesia .....	71
<b>Mulyo Harris Pradono</b> (Agency for the Assessment and Application of Technology, Indonesia) and Hirokazu Iemura Tsunami Hydrodynamic Force on Structure – Surveys in Aceh and Experimental Studies – .....	72

### **Welcome Reception with Light Buffet**

**19:00-20:00**

**Foyer of Main Hall  
1st Floor, Kenchikukaikan**



## March 4, Sunday

### HALL A

#### HA4 9:00-10:30 KEYNOTE PRESENTATIONS (3)

Moderators: Tsuyoshi Takada and Rupert Blackstone

**Hiroyuki Kameda** (Kyoto University and Japan Nuclear Energy Safety Organization)

Engineering Agenda on Nuclear Safety from the 2011 Tohoku-Pacific Earthquake ..... 73

**Hideki Nariai** (University of Tsukuba)

Fact and Cause of Fukushima Nuclear Power Plants Accident ..... 74

#### HA5 10:45-12:15 DAMAGE OF BUILDINGS (4)

Moderators: Masato Motosaka and Stephen A. Mahin

**Toshihide Kashima** (Building Research Institute), Shin Koyama, Izuru Okawa and Masanori Iiba

Strong Motion Data Recorded in Buildings Damaged by the 2011 Great East Japan Earthquake ..... 75

**Kazuya Mitsuji** (Yamagata University), Zhiwei Liu, Susumu Ohno and Masato Motosaka

Microtremor Measurements of the High-rise Buildings Leaned  
by the 2011 off the Pacific Coast of Tohoku Earthquake ..... 76

**Yukiko Nakamura** (Chiba University), Tomofusa Akita, Yuko Shimada,  
Toru Takahashi and Nobuyuki Izumi

Building Damage in Narita, Sakura and the Tone River Basin in Chiba Prefecture ..... 77

**Osamu Kaneko** (Toda Corporation), Shoichi Nakai, Mikio Futaki and Hiroshi Arai

Evaluation System of Seismic Capacity for Building Foundations  
and Case Studies on Buildings in Sendai City ..... 78

#### HA6 13:05-14:35 KEYNOTE PRESENTATIONS (4)

Moderators: Kikuo Kishimoto and Rod Smith

**Masaki Shiratori** (Yokohama National University)

Damages of Machines and Structures in Great East Japan Earthquake  
and Lessons from the Disaster ..... 79

**Ian M. Arbon** (Institution of Mechanical Engineers)

The Energy Hierarchy Approach to Optimum Use of Energy Infrastructure  
– Sharing Ideas from the UK and Other Parts of Europe – ..... 80

#### HA7 14:50-17:05 KEYNOTE PRESENTATIONS (5)

Moderators: Hitoshi Shiohara and Jack Moehle

**Masato Motosaka** (Tohoku University)

Lessons of the 2011 Great East Japan Earthquake Focused on Characteristics  
of Ground Motions and Building Damage ..... 81

**Toshimi Kabeyasawa** (University of Tokyo)

Damage Survey on Buildings and the Lessons from the 2011 East Japan Earthquake ..... 82

<b>Mikio Koshihara</b> (University of Tokyo), Naohito Kawai, Hiroshi Isoda and Takahiro Tsuchimoto Damages of Wooden Houses Caused by 2011 Great East Japan Earthquake and Tsunami .....	83
---	----

## **HA8 17:20-19:50 DAMAGE OF BUILDINGS (6)**

Moderators: Taiki Saito and Mario E. Rodriguez

<b>Taiki Saito</b> (Building Research Institute) Damage of Buildings and Actions Taken during the 2011 Great East Japan Earthquake in the Disaster Prevention Facilities .....	84
--	----

Kenji Kikuchi, Toshikazu Hanazato, <b>Masayuki Kuroki</b> (Oita University), Kazuya Koga, Katsuya Kawakami and Noriyuki Mita Results of First Reconnaissance on Damage to Reinforced Masonry Buildings and Garden Walls Caused by the Great East Japan Earthquake in 2011 .....	85
--	----

<b>Isaac Villanova</b> (Nagoya Institute of Technology), Atsushi Nagaya, Masaki Maeda, Santiago Pujol, Susumu Takahashi and Toshikatsu Ichinose Damage of Eight-story RC Building Retrofitted to Have Base Shear Coefficient of 0.65 .....	86
--	----

<b>Shih-Hsun Yin</b> (National Taipei University of Technology), Shuenn-Yih Chang, Wen-I Liao and Yu-Chi Sung Experimental Study on Seismic Retrofit of RC Column with Wing Wall in Taiwan and Japan .....	87
--	----

<b>Hamood Alwashali</b> (Tohoku University) and Masaki Maeda Study of Low-rise RC Buildings with Relatively High Seismic Capacity Damaged by Great East Japan Earthquake 2011 .....	88
---	----

<b>Mario E. Rodriguez</b> (National University of Mexico) The 2010 Maule and the 2011 Great East Japan Earthquake – Lessons Learned for the Seismic Design of Structures .....	89
--	----

<b>Andrew Taylor</b> (KPF Consulting Engineers), David Swanson, Mark Pierepiekarz, Yao Cui, Paul Brallier, Tom Xia, King Chin, Greg Hess, Jonathan Siu, Doug Lindquist and Erik Bishop Implication of the Great East Japan Earthquake for the Pacific Northwest Region of the United States .....	90
--	----

## **ROOM A**

### **A4 9:00-10:30 RECENT EARTHQUAKES (3)**

Moderators: Masaki Maeda and Kenneth Elwood

Zaheer A. Kazmi, <b>Tauqir Ahmed</b> (University of Tokyo), Umair Saleem and Muhammad Irfan Evaluation of Design and Construction Practices – A Lesson Learnt from Kashmir Earthquake – .....	91
---	----

<b>John M. Eiding</b> (G&E Engineering Systems Inc.) Performance of Buried High Voltage Power Cables due to Liquefaction .....	92
---	----

Ian Billings and <b>Nicholas Charman</b> (Beca Infrastructure Ltd) Christchurch City Lifelines - Assessment and Repair of Concrete Potable Water Reservoirs Following the February and June 2011 Christchurch Earthquakes .....	93
---	----

<b>Lian Ching Oh</b> (Ground Anchorages Limited) Restoration Post March 11 2011 Earthquake .....	94
---	----

## **A5 10:45-12:15 DAMAGE OF NUCLEAR POWER STATIONS**

Moderators: Hiroyuki Kameda and Tsuyoshi Takada

- Hirosi Miyano** (Hosei University) and Takao Nakamura  
Root Causes of the Fukushima Dai-ichi Nuclear Plant Accidents and Study of Its Cliff-edge ..... 95
- Katsumi Ebisawa** (Japan Nuclear Energy Safety Organization), Hiroyuki Kameda and Mitsumasa Hirano  
Concept for Developing Seismic-tsunami PSA Methodology Considering Combination  
of Seismic and Tsunami Events at Multi-units ..... 96
- Naotaka Takamatsu, **Hiroyuki Kameda** (Kyoto University) and Katsumi Ebisawa  
Fragility Enhancement in Seismic-tsunami Risk Reduction for Nuclear Power Plants ..... 97
- Tsuyoshi Takada** (University of Tokyo)  
Robustness and Resilience as Extensions of Risk Concept after Fukushima Event ..... 98

## **A6 13:05-14:35 RECOMMENDATIONS FOR FUTURE EARTHQUAKE RISK MITIGATION**

Moderator: Kazuhiko Kawashima

- Ikuo Towhata** (University of Tokyo)  
Appeal by the Japan Association for Earthquake Engineering
- Hitoshi Ieda** (University of Tokyo)  
Activities and products after 3.11: Efforts of Japan Society of Civil Engineers ..... 99
- Masayoshi Nakashima** (Kyoto University)  
Returning to Origin of Architecture – Restoration and Renovation of Our Living Environment  
in Response to the 2011 Tohoku Earthquake Disaster
- Fumio Tatsuoka** (Tokyo University of Science)  
Geo-hazards during Earthquakes and Mitigation Measures  
– Lessons and Recommendations from the 2011 Great East Japan Earthquake – ..... 100

## **A7 14:50-17:05 RECENT EARTHQUAKES (4)**

Moderators: Omer Aydan and Koichi Kusunoki

- Bo Song** (University of Science and Technology Beijing, China), Fuqiang Qi and Shuai Huang  
Damage Analysis on Buildings in Towns and Villages around the Junction Area  
of Sichuan and Gansu in Wenchuan Earthquake ..... 101
- Kazuo Konagai** (University of Tokyo), Resat Ulusay, Halil Kumsar, Omer Aydan and Mehmed Celebi  
The Characteristics of Seismic, Strong Motion and Structural Damage  
of the 2011 Van-Ercis Earthquake ..... 102
- Omer Aydan** (Tokai University), Halil Kumsar, Resat Ulusay, Onur Kose and Mehmet Celebi  
The Characteristics of the Triggered 2011 Van-Edremit Earthquake and Induced Damage ..... 103
- Resat Ulusay** (Hacettepe University), Halil Kumsar, Kazuo Konagai and Omer Aydan  
The Characteristics of Geotechnical Damage by the 2011 Van-Ercis Earthquake ..... 104
- Mustafa Erdik** (Bogazici University), Yaver Kamer, Mine B. Demircioglu and Karin Sesetyan  
Report on 2012 Van (Turkey) Earthquakes ..... 105
- Koichi Kusunoki** (Yokohama National University), Akira Tasai, Yo Hibino, Hidekazu Watanabe,  
Muneyoshi Numada, Mucip Tapan and Alper Ilki  
Quick Report of 2011 Van Earthquake ..... 106

## **A8 17:20-19:50 EVACUATION, REPAIR AND RESTORATION (3)**

Moderators: Kimiro Meguro and Peter Fajfar

**Kota Kawasaki** (Fukushima University)

Current Status of Municipal Planning Activities for the Revitalization  
of Fukushima Prefecture: Special Focus on Non-statutory Municipal Decontamination Plans ..... 107

**Tomoaki Nishino** (Kobe University), Masaaki Ouchi, Shin-ichi Tsuburaya,  
Takeyoshi Tanaka and Akihiko Hokugo

Emergency Evacuation of Fukushima Residents Living in the Vicinity  
of Nuclear Power Station ..... 108

**Miho Ohara** (University of Tokyo), Kimiro Meguro and Atsushi Tanaka

A Comparative Study on People's Awareness of Earthquake Early Warning before  
and after the 2011 Great East Japan Earthquake ..... 109

Gaku Shoji, **Tomoharu Nakamura** (University of Tsukuba) and Kazunori Takahashi  
Tsunami Damage Assessment on Road Structures in the 2011

Off the Pacific Coast of Tohoku Earthquake ..... 110

## **ROOM B**

### **B4 9:00-10:30 FAULT MECHANISM (1)**

Moderators: Teruyuki Kato and Toru Matsuzawa

**Toru Matsuzawa** (Tohoku University) and Yoshihisa Iio

The Reasons Why We Failed to Anticipate M9 Earthquakes in Northeast Japan ..... 111

**Makoto Kamiyama** (Tohoku Institute of Technology), Masato Sugito and Masamitsu Kuse

Precursor of Crustal Movements before the 2011 Great East Japan Earthquake ..... 112

**Yasutake Ikeda** (University of Tokyo)

Long-term Strain Buildup in the Northeast Japan Arc-trench System and Its Implications  
for the Gigantic Subduction Earthquake of March 11, 2011 ..... 113

**Takashi Nakata** (Hiroshima University), Hideaki Goto, Mitsuhsa Watanabe, Yasuhiro Suzuki,  
Azusa Nishizawa, Noriaki Izumi, Daishi Horiuchi and Yukari Kido

Active Faults along Japan Trench and Source Faults of Large Earthquakes ..... 114

### **B5 10:45-12:15 FAULT MECHANISM (2)**

Moderators: Teruyuki Kato and Masayuki Yoshimi

**Masayuki Yoshimi** (National Institute of Advanced Industrial Science and Technology)  
and Haruko Sekiguchi and Haruo Horikawa

Ground Motion Simulations for Great Interplate Earthquakes around Japan:  
Variability of Ground Motion Resulted from Complexity in Source Models ..... 115

**Dapeng Zhao** (Tohoku University)

Mechanism of the 2011 Tohoku-oki Earthquake: Insight from Seismic Tomography ..... 116

**Takeshi Tsuji** (Kyoto University), Yoshihiro Ito, Kiichiro Kawamura, Toshiya Kanamatsu,  
Takafumi Kasaya, Masataka Kinoshita and Toshifumi Matsuoka

Seismogenic Faults of the 2011 Great East Japan Earthquake:  
Insight from Seismic Data and Seafloor Observations ..... 117

<b>Zaheer A. Kazmi</b> (University of Tokyo), Kazuo Konagai, Cigdem Tetik, Jonathan Bray and Ashley Streig Fault Rupture and Associated Geo-hazards of Fukushima-prefecture Hamadoori Earthquake .....	118
--	-----

## **B6 13:05-14:35 FIRE**

Moderators: Takeyoshi Tanaka and Yoshifumi Ohmiya

<b>Ai Sekizawa</b> (Tokyo University of Science) and Katsunori Sasaki Overview of Fires Following the Great East Japan Earthquake .....	119
--	-----

<b>Tokiyoshi Yamada</b> (University of Tokyo), U Hiroi and Noriaki Sakamoto Aspects of Fire Occurrences Caused by Tsunami .....	120
--	-----

<b>Haruki Nishi</b> (National Research Institute of Fire and Disaster) Damage on Hazardous Materials Facilities .....	121
--	-----

<b>Charles Scawthorn</b> (Waseda University) Fire Following Earthquake – Analysis and Mitigation in North America .....	122
--	-----

## **B7 14:50-17:05 SOIL LIQUEFACTION (3)**

Moderators: Ikuo Towhata and Ramon Verdugo

<b>Wei F. Lee</b> (National Taiwan University of Science and Technology), Kenji Ishihara and Chun Chi Chen Liquefaction of Silty Sand – Preliminary Studies from Recent Taiwan, New Zealand and Japan Earthquakes .....	123
---	-----

<b>Takaji Kokusho</b> (Chuo University), Yohta Nagao, Fumiki Ito and Takahisa Fukuyama Aging Effect on Sand Liquefaction Observed during the 2011 Earthquake and Basic Laboratory Studies .....	124
---	-----

<b>Masanori Ishihara</b> (Public Works Research Institute) and Tetsuya Sasaki Relationship between Age of Ground and Liquefaction Occurrence in the 2011 Great East Japan Earthquake .....	125
--	-----

<b>Atsuo Onoue</b> (Koa Corporation), Fei Cai, Miyoko Nakajima, Masayoshi Nishikawa, Takashi Torigoe and Kumiko Yoneda Behavior of Liquefied Soil Near Boundary of Backfilled Basin due to Main and Following Maximum Aftershock .....	126
---	-----

<b>Shinichi Higuchi</b> (Obayashi Co.) and Joji Ejiri Influence of the Earthquake Motion Characteristics on the Ground Settlement Behavior due to Liquefaction .....	127
--	-----

<b>Hideki Funahara</b> (Taisei Corporation), Sadayuki Ishizaki and Toshiaki Nagao Effective Stress Analyses of Two Sites with Different Extent of Liquefaction during East Japan Earthquake .....	128
---	-----

## **B8 17:20-19:50 SOIL LIQUEFACTION (4)**

Moderators: Kohji Tokimatsu and Ross W. Boulanger

<b>Misko Cubrinovski</b> (University of Canterbury) Duncan Henderson and Brendon Bradley Liquefaction Impacts in Residential Areas in the 2010-2011 Christchurch Earthquakes .....	129
---	-----

<b>Susumu Yasuda</b> (Tokyo Denki University) and Keisuke Ishikawa Several Features of Liquefaction-induced Damage to Houses and Buried Lifelines during the 2011 Great East Japan Earthquake .....	130
<b>Ikuo Towhata</b> (University of Tokyo) , Hiroyoshi Kiku and Yuichi Taguchi Technical and Societal Problems to be Solved in Geotechnical Issues .....	131
<b>Kazuya Ishitsuka</b> (Kyoto University), Takeshi Tsuji and Toshifumi Matsuoka Surface Change of the Soil Liquefaction Caused by the 2011 Great East Japan Earthquake Derived from SAR Data .....	132
<b>Kazuo Konagai</b> (University of Tokyo), Toru Asakura, Shota Suyama, Hiroyuki Kyokawa, Takashi Kiyota, Chikako Eto and Kenichi Shibuya Soil Subsidence Map of the Tokyo Bay Area Liquefied in the March 11th Great East Japan Earthquake .....	133
<b>Toru Sekiguchi</b> (Chiba University) and Shoichi Nakai Effects of Local Site Conditions on Liquefaction Damage in Mihama Ward of Chiba City .....	134
<b>Chinami Keino</b> (Keio University) and Masayuki Kohiyama Health Disturbance of Residents in a House with Liquefaction Damage in Mihama Ward, Chiba City .....	135

## ROOM C

### C4 9:00-10:30 DAMAGE OF LIFELINE FACILITIES (1)

Moderators: Fumio Yamazaki and Alex K. Tang

Tomohiro Higashide, Takahiro Yabuguchi, Toshio Imai and <b>Takeshi Koike</b> (Kyoto University) Seismic Performance Assessment of Expansion Joints for Water Lifelines .....	136
<b>Masakatsu Miyajima</b> (Kanazawa University) Damage to Water Supply System Induced by the 2011 Great East Japan Earthquake .....	137
<b>Yasuko Kuwata</b> (Kobe University) and Yoji Ohnishi Emergency-Response Capacity of Lifelines after Wide-Area Earthquake Disasters .....	138
<b>Satoshi Naba</b> (University of Tsukuba), Takuya Tsukiji, Gaku Shoji and Shigeru Nagata Damage Assessment on Water Supply System and Sewerage System at the 2011 Off the Pacific Coast of Tohoku Earthquake – Case Study for the Data at Ibaraki and Chiba Prefectures – .....	139

### C5 10:45-12:15 DAMAGE OF LIFELINE FACILITIES (2)

Moderators: Masakatsu Miyajima and Yasuko Kuwata

Manabu Matsuhashi, Wataru Fukatani, Toshihiro Yokota, Masaaki Ozaki and <b>Nobuyuki Horie</b> (National Institute for Land and Infrastructure Management The Damage of Sewage Treatment Systems Caused by the Great East Japan Earthquake .....	140
Wataru Inomata and <b>Yuki Norito</b> (Tokyo Gas Company) Result of SUPREME (Super-dense Real Time Monitoring Earthquake System for City Gas Supply) in the Great East Japan Earthquake .....	141
Alexis Kwasinski and <b>Alex K. Tang</b> (L&T Consultant, USA) Telecommunications Performance in the M=9.0 Off-shore East Coast of Japan Earthquake and Tsunami, March 11, 2011 .....	142

<b>Nobuoto Nojima</b> (Gifu University) Restorations and System Interactions of Lifelines in the Great East Japan Earthquake Disaster, 2011 .....	143
---	-----

## **C6 13:05-14:35 DAMAGE OF BUILDINGS (5)**

Moderators: Toshikatsu Ichinose and Bo Song

<b>Kazuya Kamataki</b> (Yokohama National University), Akira Tasai and Koichi Kusunoki Seismic Performance of Reinforced Concrete School Building in Fukushima under the Great East Japan Earthquake .....	144
--	-----

<b>Toshimi Kabeyasawa</b> (University of Tokyo), Koichi Kusunoki, Daisuke Kato, Toshikatsu Ichinose and Akira Tasai Damages of Reinforced Concrete Buildings Observed in Fukushima after the 2011 East Japan Earthquake .....	145
--	-----

<b>Kazuhiro Kitayama</b> (Tokyo Metropolitan University) Damage by the 2011 East Japan Earthquake of Reinforced Concrete School Building in Tochigi Retrofitted by Steel-braced Frame .....	146
---	-----

<b>Shinji Tokita</b> (Urban Renaissance Agency), Eiichi Inai, Yoshio Inoue, Masayoshi Iizuka, Takahiro Sasaki and Masaomi Teshigawara Damage to Reinforced Concrete Boxed Wall-buildings in the 2011 Great East Japan Earthquake .....	147
--	-----

## **C7 14:50-17:05 DAMAGE OF TRANSPORTATION FACILITIES (1)**

Moderators: Shigeki Unjoh and Phillip Yen

<b>Jun-ichi Hoshikuma</b> (Public Works Research Institute), Guangfeng Zhang and Junichi Sakai Seismic Behavior of Retrofitted Bridges during the 2011 Great East Japan Earthquake .....	148
---	-----

<b>Yoshikazu Takahashi</b> (Kyoto University) Damage of Rubber Bearings and Dampers of Bridges in 2011 Great East Japan Earthquake .....	149
---	-----

<b>Masashi Kobayashi</b> (East Japan Railway Company), Koichiro Mizuno and Tadayoshi Ishibashi Damage Caused to Shinkansen Structures by the Great East Japan Earthquake and Early Restoration .....	150
--	-----

<b>Mitsuyoshi Akiyama</b> (Waseda University) and Keita Mizuno Damage Analysis of Shinkansen Viaducts during the 2011 Great East Japan Earthquake .....	151
--	-----

<b>Ian Buckle</b> (University of Nevada, Reno), Wen-Huei Yen, Lee Marsh and Eric Monzon Implications of Bridge Performance during Great East Japan Earthquake for US Seismic Design Practice .....	152
--	-----

<b>Hiroshi Matsuzaki</b> (Tokyo Institute of Technology) and Kazuhiko Kawashima Evaluation of Strong Ground Motions of the 2011 Great East Japan Earthquake based on Nonlinear Response of Standard Bridges .....	153
---	-----

## **C8 17:20-19:50 DAMAGE OF TRANSPORTATION FACILITIES (2)**

Moderators: Yoshikazu Takahashi and Saiid Saiidi

<b>Kenji Kosa</b> (Kyushu Institute of Technology) Damage Analysis of Bridges Affected by Tsunami due to Great East Japan Earthquake .....	154
---	-----

<b>Jeremy D. Bricker</b> (Tokyo Institute of Technology), Kazuhiko Kawashima and Akihiko Nakayama CFD Analysis of Bridge Deck Failure due to Tsunami .....	155
<b>Syuehei Takeda</b> (Fukui University of Technology), Kenji Kosa, Masakatsu Miyajima and Hideaki Shimizu Summary of the Field Survey on the Damage of Bridges in the 2011 Off the Pacific Coast of Tohoku Earthquake .....	156
<b>Mark Yashinsky</b> (California Department of Transportation) Lessons for Caltrans from the 2011 Great East Japan Earthquake and Tsunami .....	157
<b>Shigeki Unjoh</b> (National Institute for Land and Infrastructure Management) Tsunami Damage to Bridge Structures in Rikuzen-Takada City and the Emergency Road Network Recovery Actions .....	158
Hua Zhang, Jianzhong Li and <b>M. Saïid Saïidi</b> (University of Nevada, Reno) Evaluation of Performance of A Skew Bridge in Wenchuan 2008 Earthquake .....	159
<b>Makoto Fujii</b> (University of Tokyo), Muneyoshi Numada, Miho Ohara and Kimiro Meguro Damage Investigation of Sanriku Railway Suffered from the 2011 Off the Pacific Coast of Tohoku Earthquake .....	160

## HALL B

### HB4 9:00-10:30 TSUNAMI (4)

Moderators: Yutaka Hayashi and Dinar Catur Istiyanto

<b>Yehuda Bock</b> (Scripps Institution of Oceanography), Diego Melgar, Brendan Crowell, Dominga Sanchez and Jose Restrepo Replay of the 2011 Mw9.0 Great East Japan Earthquake in Simulated Real-time Mode with Integrated 1 Hz GPS and 100 Hz Accelerometer Data for Rapid Source Characterization, Earthquake Response Spectra and Tsunami Prediction .....	161
<b>Akio Katsumata</b> (Meteorological Research Institute), Shigeki Aoki, Yasuhiro Yoshida, Hiroshi Ueno and Takashi Yokota Rapid Source Parameter Estimation of Great Earthquakes for Tsunami Warning .....	162
<b>Ergin Ulutas</b> (Kocaeli University) The 2011 Off the Pacific Coast of Tohoku-oki Earthquake and Tsunami: Influence of the Source Characteristics on the Maximum Tsunami Heights .....	163
<b>Anatoly Petukhin</b> (Geo-Research Institute), Kunikazu Yoshida, Ken Miyakoshi and Kojiro Irikura Tsunami Simulation for the 2011 Great Tohoku Earthquake using Seismic Inversion Source Model and Fully Nonlinear Tsunami Model .....	164

### HB5 10:45-12:15 TSUNAMI (5)

Moderators: Akio Katsumata and Adnan Ibrahimbegovic

<b>Makoto Takao</b> (Tokyo Electric Power Company), Tomoyuki Tani, Toshimichi Kaneto, Ken Yanagisawa and Tadashi Annaka Tsunami Inversion Analysis of the Great East Japan Earthquake .....	165
<b>Yutaka Hayashi</b> (Meteorological Research Institute), Hiroaki Tsushima and Yasuhiro Yoshida Real-time Detection of the Source Area of an Intense Tsunami – Case Study of the 2011 Great East Japan Earthquake .....	166



**Hiroyuki Matsumoto** (Japan Agency for Marine-Earth Science and Technology), Shusaku, Inoue, and Tatsuo Ohmachi  
Some Features of Water Pressure Change during the 2011 Tohoku Earthquake ..... 167

## **HB6 13:05-14:35 GROUND MOTIONS (1)**

Moderators: Hiroyuki Goto and Ruben Boroshek

**Saburoh Midorikawa** (Tokyo Institute of Technology), Hiroyuki Miura and Tomohiro Atsumi  
Strong Motion Records from the 2011 Off the Pacific Coast of Tohoku Earthquake ..... 168

**Hiroyuki Goto** (Kyoto University), Hitoshi Morikawa, Masayuki Inatani, Yumiko Ogura, Satoshi Tokue, Xin-Rui Zhang, Masahiro Iwasaki, Masayuki Arai and Sumio Sawada  
Preliminary Study of Ground Motion Characteristics in Furukawa District, Japan, based on Very Dense Seismic-array-observation ..... 169

**Hiroyuki Mizutani** (Tokyo Electric Power Company), Isao Nishimura and Katsuichirou Hijikata  
Strong Motion Records of the Great East Japan Earthquake Observed at Fukushima Dai-ichi Nuclear Power Plant and Fukushima Dai-ni Nuclear Power Plant ..... 170

## **HB7 14:50-17:05 GROUND MOTIONS (2)**

Moderators: Shojiro Kataoka and Florent De Martin

**Hiroshi Asahara** (University of Tokushima), Masayuki Kashiwayangi and Tsuneo Ohsumi  
Investigation of Seismic Records of the 2011 Off the Pacific Coast of Tohoku Earthquake at a Dam Site Using the Empirical Green's Function Method ..... 171

**Florent De Martin** (French Geological Survey (BRGM)), Hiroshi Kawase and Fabian Bonilla  
Inversion of Equivalent Linear Soil Parameters during the 2011 Tohoku Earthquake, Japan ..... 172

**Shoichi Nakai** (Chiba University), Toru Sekiguchi and Hiroki Ishino  
Estimation of a Deep Shear Wave Velocity Structure of Chiba City based on Arrays of Accelerometers ..... 173

**Taro Okamoto** (Tokyo Institute of Technology), Hiroshi Takenaka, Takeshi Nakamura and Takayuki Aoki  
Large-scale Simulation of Seismic-wave Propagation of the 2011 Tohoku-oki M9 Earthquake ..... 174

**Fumiaki Nagashima** (Kyoto University), Hiroshi Kawase, Shinichi Matsushima, Francisco J. Sanchez-Sesma, Takashi Hayakawa, Toshimi Satoh and Mitsutaka Oshima  
Application of the H/V Spectral Ratios for Earthquake Ground Motions and Microtremors at K-NET Sites in Tohoku Region, Japan to Delineate Soil Nonlinearity during the 2011 Off the Pacific Coast of Tohoku Earthquake ..... 175

## **HB8 17:20-19:50 GROUND MOTIONS (3)**

Moderators: Hiroyuki Fujiwara and Santiago Pujol

**Shojiro Kataoka** (National Institute for Land and Infrastructure Management) and Masahiro Kaneko  
Estimation of Strong Motion during the 2011 Off the Pacific Coast of Tohoku Earthquake by a Ground Motion Prediction Model ..... 176

**Takaaki Ikeda** (Tobishima Corporation), Kazuo Konagai and Toshihiko Katagiri  
Earthquake Behavior of the Surface Layer at Tokyo Bay Area during the 2011 Off the Pacific Coast of Tohoku Earthquake Using the Downhole Array Observation Records ..... 177

<b>Susumu Ohno</b> (Tohoku University), Masato Motosaka, Kazuya Mitsuji and Akihiro Shibayama Site Response Characteristics in Sendai City Estimated from Acceleration Records of the 2011 Tohoku Earthquake, Japan .....	178
<b>Hiroyuki Fujiwara</b> (National Research Institute for Earth Science and Disaster Prevention) and Nobuyuki Morikawa Seismic Hazard Assessment for Japan after the 2011 Tohoku-oki Mega-thrust Earthquake (Mw9.0) .....	179
<b>Yoshiya Hata</b> (Nippon Koei Co., Ltd.), Atsushi Nozu, Susumu Nakamura, Yoshikazu Takahashi and Hiroyuki Goto Strong Motion Estimation at the Elevated Bridges of the Tohoku Shinkansen Damaged by the 2011 off the Pacific Coast of Tohoku Earthquake based on Extended Site Effects Substitution Method .....	180